

BXUV.V493
Fire Resistance Ratings - ANSI/UL 263

Page Bottom

Design/System/Construction/Assembly Usage Disclaimer

- Authorities Having Jurisdiction should be consulted in all cases as to the particular requirements covering the installation and use of UL Listed or Classified products, equipment, system, devices, and materials.
- Authorities Having Jurisdiction should be consulted before construction.
- Fire resistance assemblies and products are developed by the design submitter and have been investigated by UL for compliance with applicable requirements. The published information cannot always address every construction nuance encountered in the field.
- When field issues arise, it is recommended the first contact for assistance be the technical service staff provided by the product manufacturer noted for the design. Users of fire resistance assemblies are advised to consult the general Guide Information for each product category and each group of assemblies. The Guide Information includes specifics concerning alternate materials and alternate methods of construction.
- Only products which bear UL's Mark are considered as Classified, Listed, or Recognized.

Fire Resistance Ratings - ANSI/UL 263

[See General Information for Fire Resistance Ratings - ANSI/UL 263](#)

Design No. V493

December 16, 2009

Nonbearing Wall Rating — 1 and 2 Hr

System A — 1 Hr.

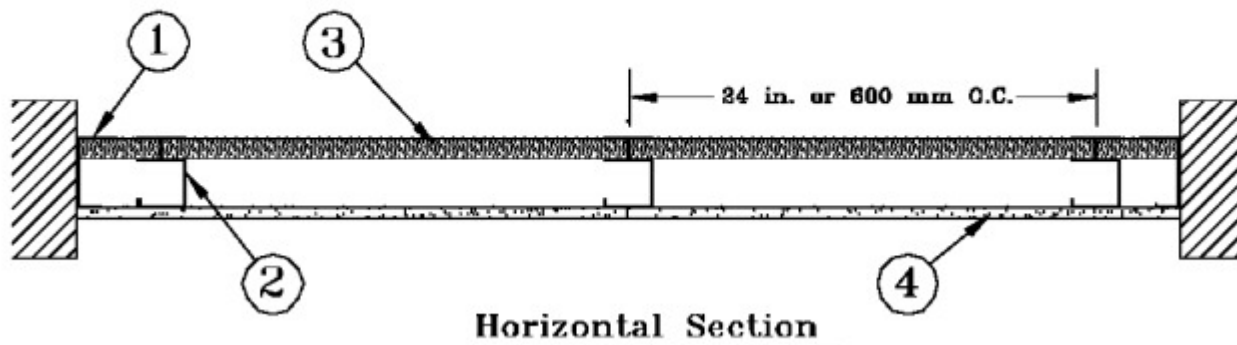

System A — 1 Hr.

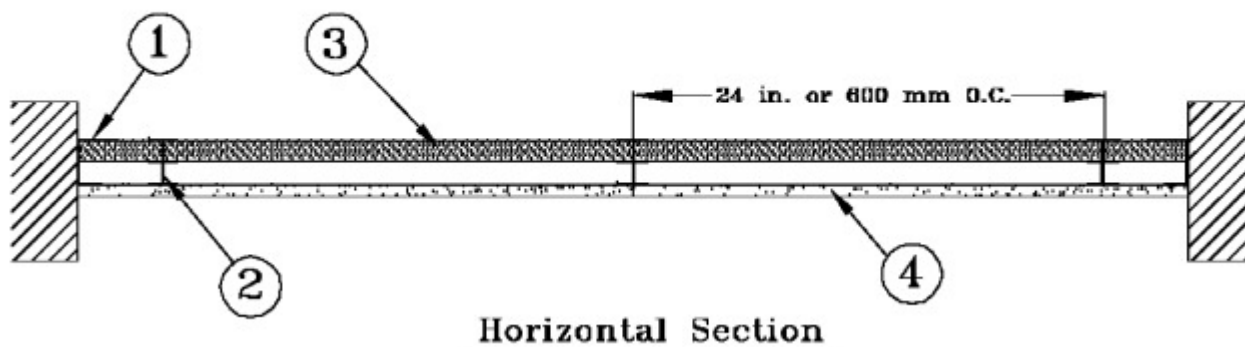

System B - 2 Hr.

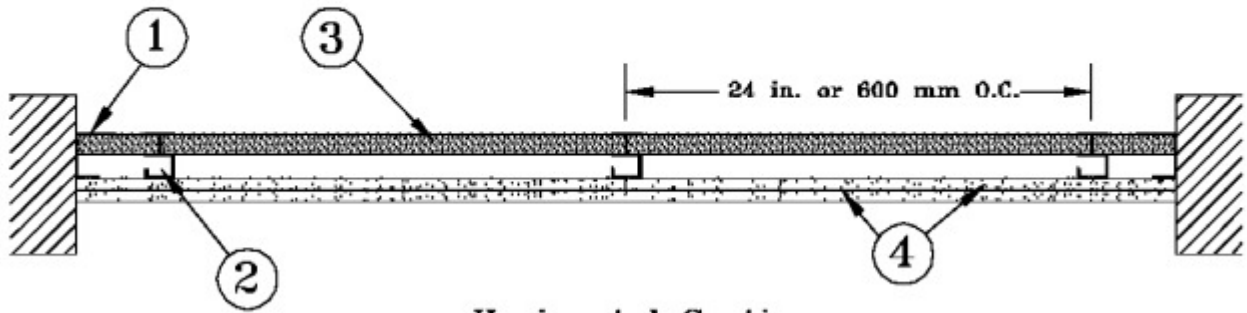

Horizontal Section

System B - 2 Hr.

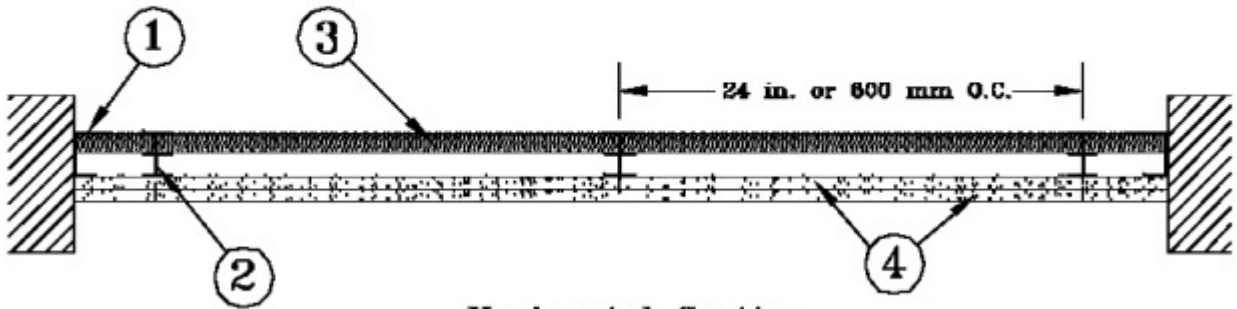

Horizontal Section

System C - 2 Hr.

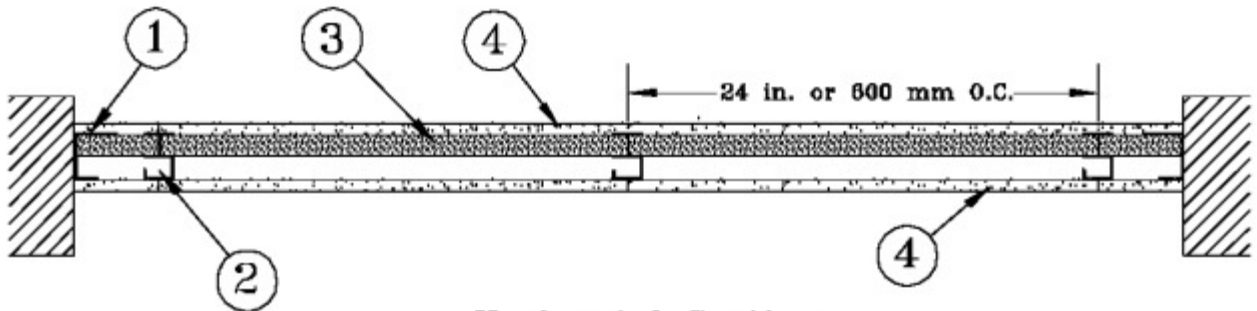

Horizontal Section

System C - 2 Hr.

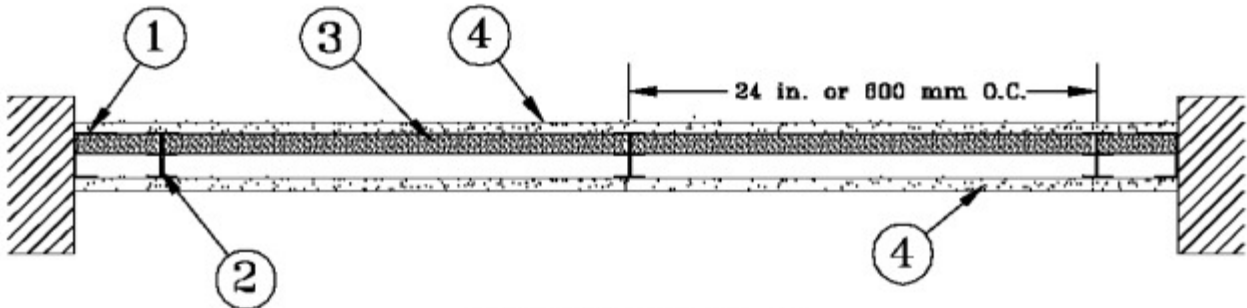

Horizontal Section

1. **Floor, Side and Ceiling Runners** — "J" -shaped runner, min 2-1/2 in. deep, with unequal legs of 1-1/8 in. and 2-1/8 in., fabricated from min 25 MSG galv steel. Runners positioned with short leg toward finished side of wall. Runners attached to structural supports with steel fasteners located not greater than 2 in. from ends and not greater than 24 in. OC.

2. **Steel Studs** — "I", "C-H, or "C-T" shaftwall studs. "C-T" or "C-H" -shaped studs, min 2-1/2 in. deep, 1-5/8 in. wide, fabricated from min 25 MSG galv steel. Cut to lengths 5/8 in. less than floor-to-ceiling height and spaced 24 in. Or, "I" -shaped studs fabricated from min 25 MSG galv steel, min 2-1/2 in. deep, 1-1/2 in. wide. Studs contain 3/4 in. wide by 2-1/4 in. high holding tabs spaced 2-3/4 in. OC on opposite sides of the stud and 12 in. vertically. Cut to lengths 5/8 in. less than floor-to-ceiling height and spaced 24 in.

2A. **Furring Channels** — (Optional, not shown) — Resilient furring channels fabricated from min 25MSG corrosion protected steel, installed horizontally, and spaced vertically a max 24 in. OC. Flange portion of channel attached to each intersecting "C-H", "C-T" or "I" stud on side of stud opposite the 1 in. liner panels with 1/2 in. long Type S or S-12 pan-head steel screws.

3. **Gypsum Board*** — Gypsum liner panels, nom 1 in. thick, 24 in. wide. Panels cut max 1/4 in. less in length than floor to ceiling height. Vertical edges inserted in "T" -shaped section of "C-T" studs, Vertical edges inserted in "H" -shaped section of "C-H" studs, or holding tabs of "I" studs. Free edge of end panels attached to long leg of "J" -runners with 1-5/8 in. long Type S bugle head steel screws spaced not greater than 12 in. OC.

TEMPLE-INLAND — Type TP-6

System A

4. **Gypsum Board*** — Gypsum panels, nom 5/8 in. thick, 48 in. wide, applied vertically or horizontally with edges centered over studs, with 1 in. long Type S bugle head steel screws spaced 12 in. OC when applied vertically, or 8 in. OC when applied horizontally. Type X ComfortGuard Sound Deadening Gypsum Board to be installed vertically only.

TEMPLE-INLAND — Type X, Veneer Plaster Base-Type X, Water Rated-Type X, Sheathing Type-X, Soffit-Type X, Greenglass Type X, TG-C, Type X ComfortGuard Sound Deadening Gypsum Board.

System B

1/2 or 5/8 in. thick, 4 ft wide, applied in two layers. Base layer attached horizontally to studs and side "J" runners with 1 in. long Type S self-tapping steel screws starting at 2 in. from the floor and ceiling runners and spaced a maximum 24 in. OC along the vertical edges and in the field of the boards. Type X ComfortGuard Sound Deadening Gypsum Board to be installed vertically only as described above with screws spaced a maximum 12 in. OC.

Face layer applied vertically to studs and side "J" runners and attached with 1-5/8 in. long Type S self-tapping steel screws, starting at 3 in. from the floor and ceiling runners and spaced a maximum 12 in. OC along the vertical edges and in the field of the boards. Face layer joints covered with paper tape and two coats of joint compound. Exposed screw heads covered with two coats of joint compound.

TEMPLE-INLAND — 1/2 or 5/8 in. Type TG-C, 5/8 in. Type X, Veneer Plaster Base-Type X, Water Rated-Type X, Sheathing Type-X, Soffit-Type X, Greenglass Type X, Type X ComfortGuard Sound Deadening Gypsum Board.

System C

1/2 or 5/8 in. thick, 4 ft wide, applied vertically and attached to studs and runners with 1 in. long Type S steel screws starting at 2 in. from the top and the bottom, and spaced at 12 in. OC. Vertical joints are offset one stud space each side. Outer layer joints covered with paper tape and two coats of joint compound. Exposed screw heads covered with two coats of joint compound.

TEMPLE-INLAND — 1/2 or 5/8 in. Type TG-C, 5/8 in. Type X, Veneer Plaster Base-Type X, Water Rated-Type X, Sheathing Type-X, Soffit-Type X, Greenglass Type X, Type X ComfortGuard Sound Deadening Gypsum Board.

5. **Joint Tape and Compound** — (Not shown) — Joints covered with joint compound and paper or mesh tape. Screw heads covered with joint compound.

6. **Batts and Blankets*** — (Optional- Not Shown) — Mineral wool or glass fiber batts partially or completely filling stud cavity. Any mineral wool or glass fiber batt mineral bearing the UL Classification Marking as to Fire Resistance. See Batt and Blankets (BZJZ) category for names of Classified Companies.

6A. **Fiber, Sprayed*** — As an alternate to Batts and Blankets (Item 6) — Spray applied cellulose material. The fiber is applied with water to completely fill the enclosed cavity in accordance with the application instructions supplied with the product. Nominal dry density of 3.0 lb/ft³. Alternate application method: The fiber is applied with U.S. Greenfiber LLC Type AD100 hot melt adhesive at a nominal ratio of one part adhesive to 6.6 parts fiber to completely fill the enclosed cavity in accordance with the application instructions supplied with the product. Nominal dry density of 2.5 lb/ft³.

U S GREENFIBER L L C — Cocoon2 Stabilized or Cocoon-FRM (Fire Rated Material)

6B. **Fiber, Sprayed*** — As an alternate to Batts and Blankets (Item 6) - Spray applied cellulose insulation material. The fiber is applied with water to interior surfaces in accordance with the application instructions supplied with the product. Applied to completely fill the enclosed cavity. Minimum dry density of 4.3 pounds per cubic ft.

*Bearing the UL Classification Mark

Last Updated on 2009-12-16

[Questions?](#)

[Print this page](#)

[Notice of Disclaimer](#)

[Page Top](#)

[Copyright © 2010 Underwriters Laboratories Inc.®](#)

The appearance of a company's name or product in this database does not in itself assure that products so identified have been manufactured under UL's Follow-Up Service. Only those products bearing the UL Mark should be considered to be Listed and covered under UL's Follow-Up Service. Always look for the Mark on the product.

UL permits the reproduction of the material contained in the Online Certification Directory subject to the following conditions: 1. The Guide Information, Designs and/or Listings (files) must be presented in their entirety and in a non-misleading manner, without any manipulation of the data (or drawings). 2. The statement "Reprinted from the Online Certifications Directory with permission from Underwriters Laboratories Inc." must appear adjacent to the extracted material. In addition, the reprinted material must include a copyright notice in the following format: "Copyright © 2010 Underwriters Laboratories Inc.®"

An independent organization working for a safer world with integrity, precision and knowledge.

